

RoHS Compliant

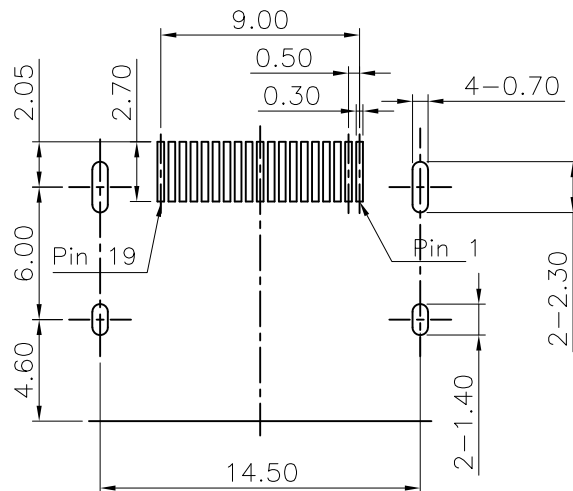

PCB LAYOUT

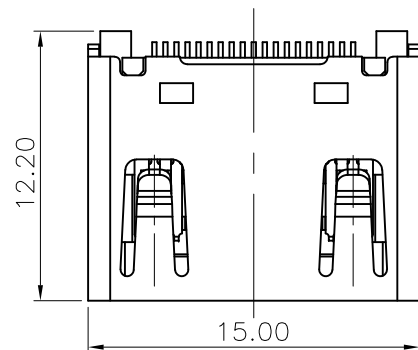
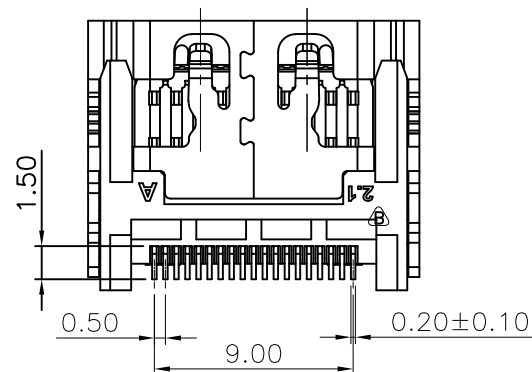
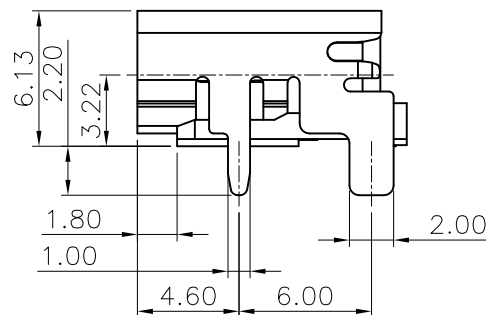
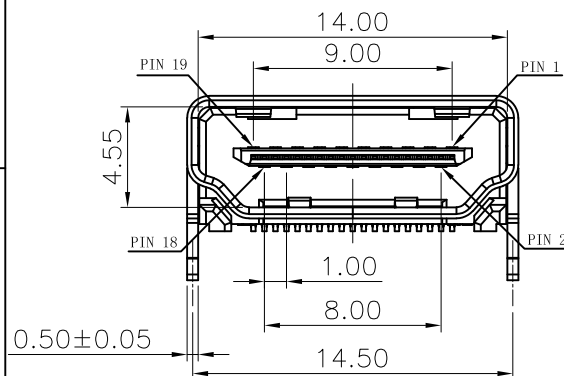

规格说明：Specifications:

电气特性：Electrical:

额定电流：Contact Current Rating:0.5 A

接触阻抗：Change from initial value
30mΩ maximum

耐电压：Dielectric Withstanding Voltage
300V AC AT seaLevoL

绝缘电阻:Insulation Resistance:
100MEGA ohms MIN

Temperature Range:-20℃ to +85℃

物理性能：Mechanical:

插拔力:Cnnector Mate and Unmate Force

Insertion force:4.5kgf(MAX)

Withdrawal force:1kgf-4.0kgf

寿命测试：Durability：10000cycles

Environment characteristics:

1. Operating temperature: -30℃ to +85℃

2. Storage Condition:

Temperature: -5℃ to +30℃

Humidity: 20%-75%

备注:

1. 材质:

胶芯: (见料号说明)。

端子: C2680 T=0.20mm

外壳: C2680 T=0.50mm

2. 电镀:

端子: 接触区镀金(见料号说明), 焊锡区镀锡50u"MIN.

外壳: 镀镍30u"MIN.

660 - 00408 - XXX-XX

SERIES CODE

FEMALE

Mould FLOW NO.

FLOW NO.

MATERIAL:A:LCP

1: TRAY PACKAGING

2: TAPE REEL PACKAGE

1.RoHS 2.HALOGEN FREE

PLATING:

1:G/F 4:Gold 10u"

2:Gold 3u" 5:Gold 15u"

3:Gold 5u" 6:Gold 30u"

COLOR: 5:BLACK

—	B	22.09.04	更新图纸	Y.XW	Kim
—	A	18.06.27	NEW RELEASE	P.H	Kim
ECN. NO	REV	DATE	DESCRIPTION	CHANGED	APPROVED

▼ = Places
DIM NO. ☉
SCALE: FIT
SHEET: 1 OF 1
UNIT: mm

TOLERANCES UNLESS	
X. ± 0.50	X° ± 3'
.X ± 0.35	.X° ± 2'
.XX ± 0.25	.XX° ± 1'
.XXX ± 0.15	.XXX° ± 0.5'

鉅創科技有限公司	
TRONTEK TECHNOLOGY CO.,LTD.	
DESIGN:KJX	DATE: 2018.06.27
HECKED: KZ	DATE: (2.1版)
APPROVED:	DATE:
PART NO: 660-00408-XXX-XX	SIZE: A4
DWG NO: 660-00408-XXX-XX	REV: B

RoHS Compliant

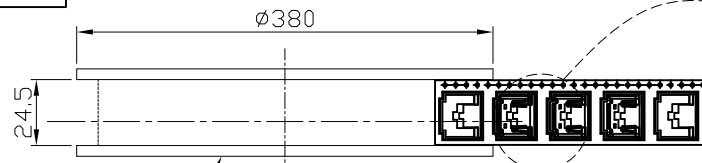

黑色卷盘

$\phi 1.5^{+0.1}_{-0.0}$

端子朝向

24.0±0.3

盖带剥离方向 Δ

剥离拉力约为10-130gf

包装说明:

1.数量: 每盘=500Pcs,

每箱=5000Pcs

2.每10盘装一箱, 外箱中加干燥剂。

纸箱内上下各放气泡垫1张

3.外箱尺寸: 345*345*310MM Δ

4. 标签格式及内容按客户出货要求

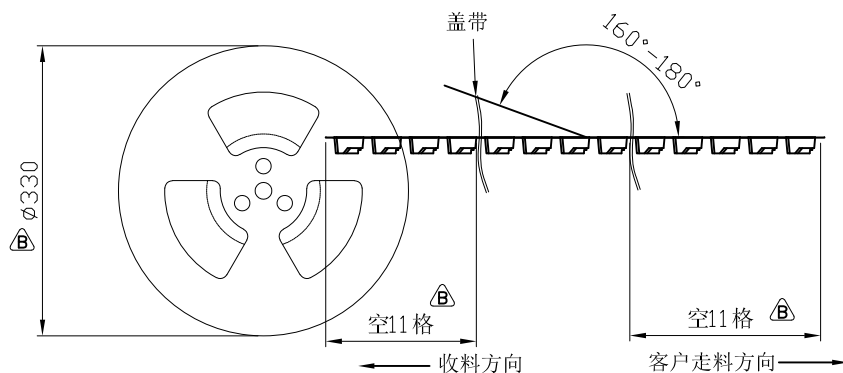

防水袋

干燥剂 (2PCS)

外箱四个角各放置
一个护角

透明封箱胶

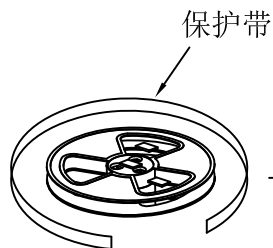
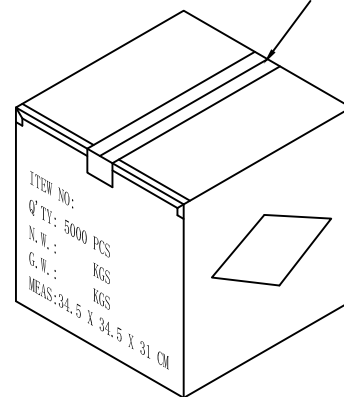

每盘最外圈缠
一圈保护带

十盘叠好套防水袋
再装箱

—	B	24.04.23	修改卷盘大小, 空格数量及纸箱规格	FX.C	Kim
—	A	18.06.27	NEW RELEASE	FX.C	Kim
ECN. NO	REV	DATE	DESCRIPTION	CHANGED	APPROVED

▼ = Places
DIM NO. \otimes
SCALE: FIT
SHEET: 1 OF 1
UNIT: mm

TOLERANCES UNLESS	
X ± 0.50	X ^o ± 3°
.X ± 0.35	X ^o ± 2°
.XX ± 0.25	.XX ^o ± 1°
.XXX ± 0.15	.XXX ± 0.5°

鉠創科技有限公司	
TRONTEK TECHNOLOGY CO., LTD.	
DESIGN:BJ	DATE: 2018.06.27
CHECKED:	DATE:
APPROVED:	DATE:
PART NO: 660-00408-XXX-X2	SIZE: A4
DWG NO: 660-00408-XXX-X2	REV: B