

REV.	ECN NO.	LOCATIONS.	DESCRIPTION	DATE	CHANGER
------	---------	------------	-------------	------	---------

- NOTES:
1. MATERIAL:
HOUSING: LCP WITH 30% G/F UL94 V-0
COLOR: BLACK
CONTACT: BRASS C2680R EH, T=0.25mm
BOARD LOCK: BRASS C2680R H, T=0.30mm
2. FINISH:
CONTACT: 1u" GOLD/TIN PLATING ON CONTACT AREA
100u" MIN. TIN PLATING ON SOLDERTAILS
50u" MIN. NICKEL UNDERPLATING OVER ALL
BOARD LOCK: 100u" MIN. TIN PLATING ON SOLDERTAILS
50u" MIN. NICKEL UNDERPLATING OVER ALL

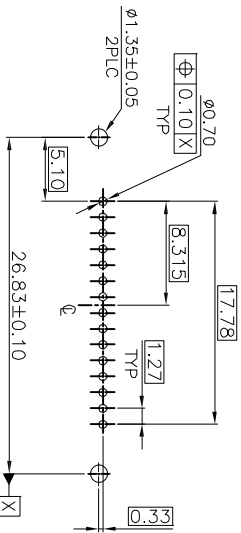
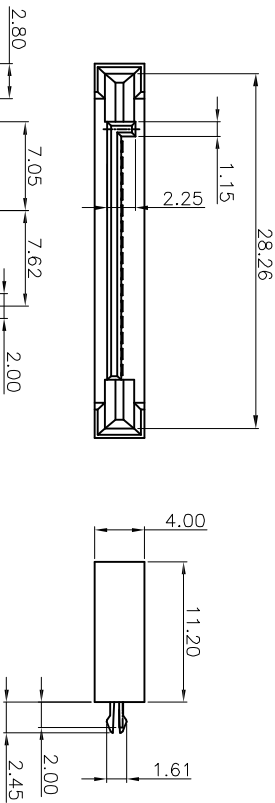
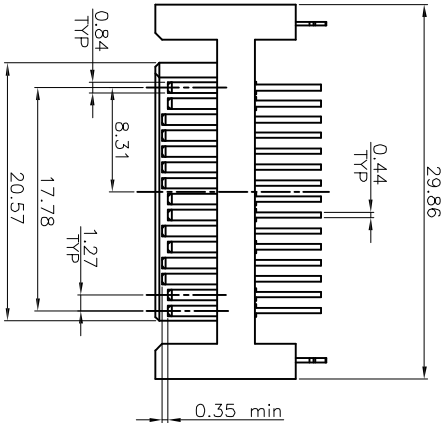

RECOMMENDED PCB LAYOUT
TOLERANCE: ±0.05

GENERAL TOLERANCE		鉅創科技有限公司 TRONTEK TECHNOLOGY CO., LTD. TITLE: SATA 15P MALE VERTICAL DIP WITH TWD LATCHES	
X±	X± 1°		
.X± 0.25	.X±		
.XX± 0.15	.XX±		
XXX± 0.08	XXX±	PART NO: SATA15MSL-LCP	DWG NO: 20130719

CUSTOMER DRAWING

APPROVED	CHECKED	DRAWN	III	SCALE	SHEET
Linda	Paul	sunny	mm	1:1	1 / 1
				PROJ	REV
					A