

REV.	ECN NO.	LOCATIONS	DESCRIPTION	DATE	CHANGER

CIRCUIT DIAGRAM

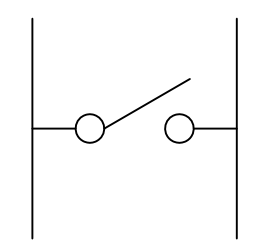

P.C.B LAYOUT

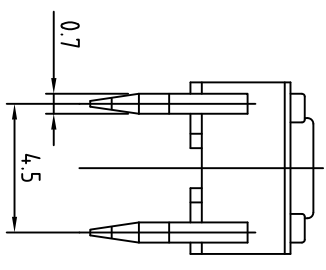
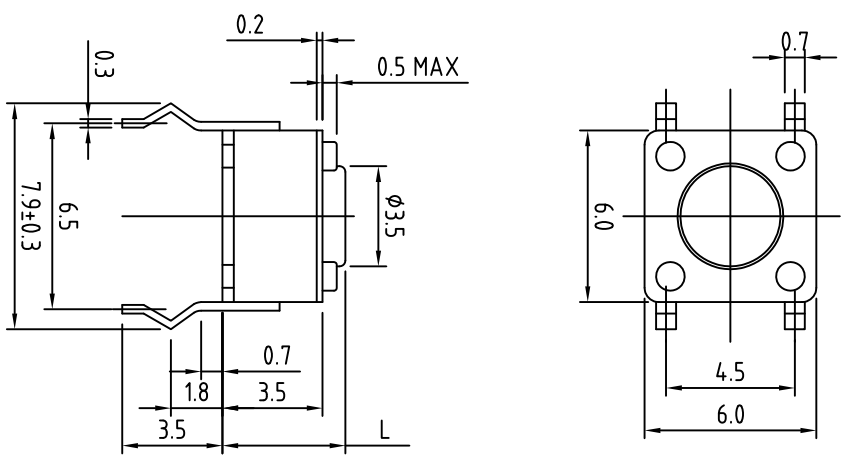
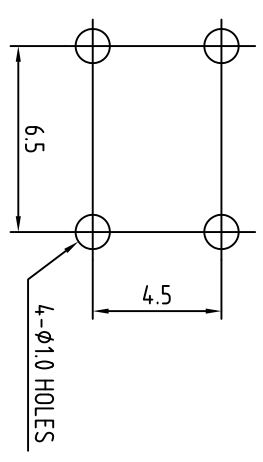

MODEL NO.	A	I	B	E	C	J	D	K	M	F	N	G	Q	R	V	X	T	H	S	W	
L(mm)	4.30	5.00	6.00	7.00	7.30	8.00	9.00	9.50	11.00	12.00	12.50	13.00	13.50	14.0	15.00	16.00	17.00	7.30	6.50	19.0	21.0

1. Rating : DC 12V, 50mA
2. Travel : 0.25±0.1m/m
3. Operating Force : 100 / 130 / 160 ±30gf
or 250 ±50gf
4. Contact Resistance : 100m Ω MAX
5. Life : 100,000 Cycles

ITEM	DESCRIPTION	Q.TY	MATERIALS	TREATMENT	REMARK
1	STEM	1	Nylon 66 (L:20/21mm USE PC MATERIAL)		
2	COVER	1	SPCC-SD	WITH NI PLATING	
3	CONTACTOR	1	PHOSPHOR BRONZE	WITH SILVER CLADDING	
4	TERMINAL	1	BRASS	WITH SILVER CLADDING	
5	BASE	1	HIGH-TEMP THERMOPLASTIC NYLON 66	MOLDED BLACK	

GENERAL TOLERANCE		TITLE:	
X±	X*± 1°	tact SWITCH	
X± 0.15	X*±	TRONTEK TECHNOLOGY CO., LTD.	
XX± 0.10	XX*±		
.XXX± 0.05	.XXX*±		

CUSTOMER DRAWING		DRAWN:		SCALE:		SHEET:	
APPROVED	CHECKED:	sunny	mm	6:1	1 / 1		
EVEN	EVEN						

鉅創科技有限公司

TRONTEK TECHNOLOGY CO., LTD.

TACT SWITCH

RS6601H SERIES

20130512

SCALE: 6:1	SHEET: 1 / 1
	A