

SECTION A-A
SCALE 1:1

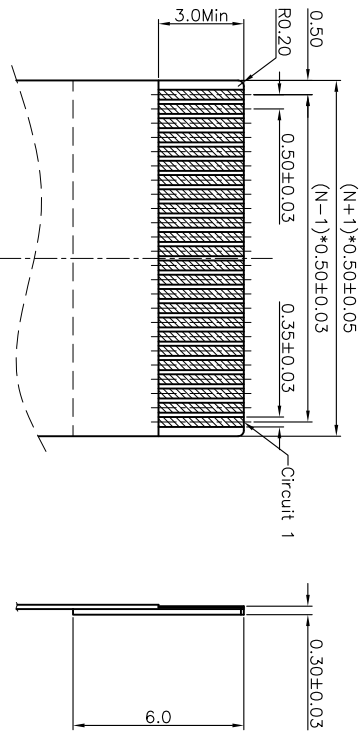
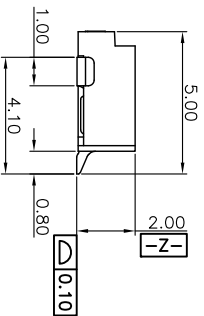

RECOMMENDED PFC/FCC DIMENSION

- Note:
- Material:
 - Housing: thermoplastic high temp.U194V-0; Color: natural.
 - Terminal: copper alloy.
 - Fitting Notch: copper alloy.
 - Finish:
 - Underplating: Au/matt Tin overall.
 - Fitting Notch: Underplating: matt Tin overall.
 - Product must comply HF RoHS specification.
 - Product No: **TFP592-XX** X X - 00

4. Product No: **TFP592-XX** X X - 00
- Series No: _____
- No. of Circuits _____
- PLATING _____
- 1:Gold flash 1u"
2:Gold flash 2u"
3:Gold flash 3u"
B:Bright-Tin 90-120u"
C:Matt-Tin 90-120u"
- PACKING _____
- A:Tube&Reel
C:Tube
- REMARKS
Hf-Hydrogen free

CKTS	DIM A	DIM B	DIM C	DIM D
6	2.50	3.60	6.50	8.40
7	3.00	4.10	7.00	8.90
8	3.50	4.60	7.50	9.40
9	4.00	5.10	8.00	9.90
10	4.50	5.60	8.50	10.40
11	5.00	6.10	9.00	10.90
12	5.50	6.60	9.50	11.40
13	6.00	7.10	10.00	11.90
14	6.50	7.60	10.50	12.40
15	7.00	8.10	11.00	12.90
16	7.50	8.60	11.50	13.40
17	8.00	9.10	12.00	13.90
18	8.50	9.60	12.50	14.40
19	9.00	10.10	13.00	14.90
20	9.50	10.60	13.50	15.40
21	10.00	11.10	14.00	15.90
22	10.50	11.60	14.50	16.40
23	11.00	12.10	15.00	16.90
24	11.50	12.60	15.50	17.40
25	12.00	13.10	16.00	17.90
26	12.50	13.60	16.50	18.40
27	13.00	14.10	17.00	18.90
28	13.50	14.60	17.50	19.40
29	14.00	15.10	18.00	19.90
30	14.50	15.60	18.50	20.40
31	15.00	16.10	19.00	20.90
32	15.50	16.60	19.50	21.40
33	16.00	17.10	20.00	21.90
34	16.50	17.60	20.50	22.40
35	17.00	18.10	21.00	22.90
36	17.50	18.60	21.50	23.40
37	18.00	19.10	22.00	23.90
38	18.50	19.60	22.50	24.40
39	19.00	20.10	23.00	24.90
40	19.50	20.60	23.50	25.40
41	20.00	21.10	24.00	25.90
42	20.50	21.60	24.50	26.40
43	21.00	22.10	25.00	26.90
44	21.50	22.60	25.50	27.40
45	22.00	23.10	26.00	27.90
46	22.50	23.60	26.50	28.40
47	23.00	24.10	27.00	28.90
48	23.50	24.60	27.50	29.40
49	24.00	25.10	28.00	29.90
50	24.50	25.60	28.50	30.40

CUSTOMER DRAWING

Product Name: **鉦創科技有限公司**
TRONTEK TECHNOLOGY CO., LTD.

Tolerance Unspecified Size: A4
 Unit: MM
 Scale: 1:1
 Project View: I OF I
 Rev: A

Product No: 0.5Pitch H=2.0 PFC Not-ZIP R/A Type3 SMT CONN
 TFP592-XXXX-00

Designer: Aihan 03/23/11

Checked: _____
 Approved: _____

RECOMMENDED PCB PATTERN LAYOUT

RECOMMENDED PFC/FCC DIMENSION